

CARBIDE**HSS****V7 Mill INOX
END MILLS****EMB72 SERIES**

PLAIN SHANK

EMB73 SERIES

FLAT SHANK

CARBIDE, 5 FLUTE REGULAR LENGTH

- ▶ Special flute geometry eliminates vibrations
- ▶ Designed for mild steels, stainless steel, cast iron, tool steels, titanium alloys, prehardened steels and low hardness material
- ▶ Excellent work piece finishes
- ▶ Higher speeds, deeper cuts and metal removal rates

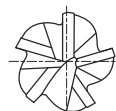

P.688

◇ Call for Availability

Unit : mm

EDP No.		Mill Diameter		Shank Diameter	Length of Cut	Overall Length
PLAIN	FLAT	Metric	Inch			
EMB72060	EMB73060	6.0	.2362	6	13	57
EMB72080	EMB73080	8.0	.3150	8	19	63
EMB72100	EMB73100	10.0	.3937	10	22	72
EMB72120	EMB73120	12.0	.4724	12	26	83
EMB72140	EMB73140	14.0	.5512	14	26	83
EMB72160	EMB73160	16.0	.6299	16	32	92
EMB72180	EMB73180	18.0	.7087	18	32	92
EMB72200	EMB73200	20.0	.7874	20	38	104
EMB72250	EMB73250	25.0	.9800	25	38	104

Mill Dia. Tolerance (inch)	Shank Dia. Tolerance
0~--.0012	h6



Carbon Steels	Alloy Steels	Prehardened Steels	Hardened Steels		High Hardened Steels	Copper	Graphite	Cast Iron	Aluminum	Stainless Steels	Titanium	Inconel
~HRc20	HRc20~30	HRc30~40	HRc40~45	HRc45~55	HRc55~70							
◎	○	○								◎	◎	○

◎ : Excellent ○ : Good



**V7 Mill INOX
END MILLS**

RECOMMENDED CUTTING CONDITIONS

CBN
END MILL

i-Xmill
END MILL

X5070
END MILLS

4G MILLS
END MILLS

X-SPEED
ROUGHER
END MILLS

X-POWER
END MILLS

JET-POWER
END MILLS

V7 Mill STEEL
END MILLS

V7 Mill INOX
END MILLS

ALU-POWER
END MILLS

D-POWER
END MILLS

STANDARD
CARBIDE
END MILLS

TANK-POWER
END MILLS

STANDARD
COBALT
& HSS
END MILLS

TECHNICAL
DATA

CARBIDE, 4 FLUTE BALL NOSE

EMB74, EMB75, EMB78, EMB79 SERIES

MATERIAL	ALLOY STEELS CAST IRON		STAINLESS STEELS 300SERIES		STAINLESS STEELS 400SERIES		TITANIUM		INCONEL	
HARDNESS	~HRc 20									
STRENGTH	~1000N/mm ²									
DIAMETER	RPM	FEED	RPM	FEED	RPM	FEED	RPM	FEED	RPM	FEED
1/8	13530	53.2	7770	24.2	7020	16.4	5510	10.4	3010	5.2
3/16	9020	42.6	5180	20.3	4680	18.2	3680	8.7	2010	3.3
1/4	6770	40.7	3880	24.9	3510	16.4	2760	8.6	1500	3.7
5/16	5410	50.8	3110	21.9	2810	17.5	2210	10.4	1200	4.8
3/8	4510	42.6	2590	20.3	2340	16.6	1840	8.7	1000	4.2
7/16	3870	39.5	2220	18.3	2010	15.0	1580	8.6	860	4.4
1/2	3380	37.2	1940	16.8	1750	13.8	1380	8.6	750	4.5
9/16	3010	34.2	1730	15.6	1560	12.8	1230	8.0	670	4.5
5/8	2710	31.8	1550	14.7	1400	11.9	1100	7.6	600	4.4
3/4	2260	32.0	1290	13.3	1170	10.8	920	8.7	500	4.2
1	1690	26.5	970	10.7	880	8.2	690	7.4	380	3.1

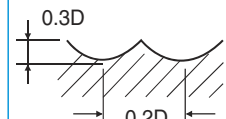
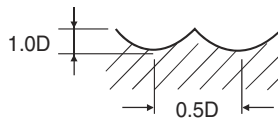

RPM = rev./min.
FEED = inch/min.

CARBIDE, 5 FLUTE

EMB72, EMB73, EMB76, EMB77 SERIES

MATERIAL	ALLOY STEELS CAST IRON		STAINLESS STEELS 300SERIES		STAINLESS STEELS 400SERIES		TITANIUM		INCONEL	
HARDNESS	~HRc 20									
STRENGTH	~1000N/mm ²									
DIAMETER	RPM	FEED	RPM	FEED	RPM	FEED	RPM	FEED	RPM	FEED
1/4	6870	46.1	5710	34.2	5310	31.8	4200	24.9	1350	4.4
5/16	5490	41.3	4570	28.6	4250	26.5	3360	20.6	1080	4.3
3/8	4580	45.5	3810	28.5	3540	26.3	2800	20.7	900	4.5
7/16	3920	44.0	3270	32.6	3040	23.9	2400	20.8	770	4.7
1/2	3430	42.8	2860	35.7	2660	22.1	2100	20.8	680	4.8
9/16	3050	41.7	2540	32.7	2360	29.6	1860	20.9	600	5.4
5/8	2750	41.4	2290	30.9	2130	28.4	1680	20.7	540	5.1
3/4	2290	39.6	1900	28.6	1770	26.4	1400	20.7	450	5.4
1	1720	34.2	1430	24.8	1330	23.2	1050	18.3	340	5.1

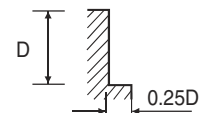
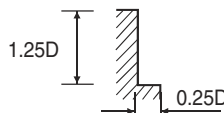

RPM = rev./min.
FEED = inch/min.